



## Price List and Exploded View

Effective 01-01-07

Team Losi, A Division of Horizon Hobby, Inc.

Not Responsible for Typographical Errors

Prices Subject to Change Without Notice

LOSA0802	8IGHT-T Off-Road Racing Truggy .....	LOSA4413	Front Chassis Brace Set.....	\$5.00	
LOSA1702	Front Suspension Arm Set.....	\$15.99	LOSA4414	Rear Chassis Brace.....	\$3.00
LOSA1701	Front Susp. Arm Bushings .....	\$3.00	LOSA4415	Center Diff Mount & Brace Set .....	\$5.00
LOSA1707	Front Spindles .....	\$10.00	LOSA4418	Radio Tray & Mounts.....	\$15.99
LOSA1710	Front Spindle Carriers .....	\$11.99	LOSA4419	Switch Cover .....	\$3.00
LOSA1716	Shock Tower Front 8T.....	\$29.99	LOSA4422	Front Bumper, Tank & Filter Guard.....	\$4.00
LOSA1723	Rear Suspension Arms & Mts .....	\$13.99	LOSA4424	Body Posts & Tank Mounts (8 & 8T) .....	\$5.00
LOSA1730	Rear Hub Carriers.....	\$7.00	LOSA4426	Chassis Spacer/Cap Set .....	\$5.00
LOSA1737	Shock Tower Rear 8T.....	\$31.99	LOSA4427	Front Gearbox Set .....	\$8.00
LOSA1744	Front Hinge Pin Brace Set - AL .....	\$8.99	LOSA4428	Rear Gearbox Set.....	\$10.99
LOSA1745	Rear Inner Hinge Pin Brace.....	\$4.00	LOSA4429	Rear Gearbox Bearing Inserts .....	\$3.00
LOSA1748	Rear Outer Hinge Pin Brace 2T/3A.....	\$11.99	LOSA4431	Hinge Pin Brace Cover Set.....	\$5.00
LOSA1750	Sway Bar Set .....	\$19.99	LOSA4435	Wing Mount Set .....	\$8.00
LOSA3500	Diff Housing F/R/C .....	\$6.00	LOSA4436	Body Mount Set (8T) (4).....	\$3.50
LOSA3502	Differential Gear & Shaft Set.....	\$11.99	LOSA4437	Chassis Guard Set (8T).....	\$12.00
LOSA3503	F/R H.D. Diff Outdrive Cups & Pins .....	\$12.99	LOSA5401	15mm Shock Body 42.6mm.....	\$24.99
LOSA3505	Diff Seal Set; .....	\$3.50	LOSA5403	15mm Shock Body 50.5mm.....	\$24.99
LOSA3506	Center Diff Outdrive Cups & Pins .....	\$10.99	LOSA5411	15mm Shock Shaft 4x50mm .....	\$8.00
LOSA3507	F/R Diff Pinion Gear (10T) .....	\$13.99	LOSA5413	15mm Shock Shaft 4x57mm .....	\$8.00
LOSA3511	Front Diff Ring Gear (43T) .....	\$24.99	LOSA5419	15mm Shock Tool Set .....	\$4.50
LOSA3512	Rear Diff Ring Gear (43T) .....	\$26.99	LOSA5420	15mm Shock Caps Top - (2).....	\$14.99
LOSA3514	F/R Diff Pinion Couplers .....	\$10.99	LOSA5421	15mm Shock Caps Bottom - (2).....	\$9.00
LOSA3516	Center Diff 48T Spur Gear .....	\$24.99	LOSA5424	15mm Shock Adjuster Nuts - (4).....	\$19.99
LOSA3519	F/R CV Driveshaft Set - (2)(8T) .....	\$43.99	LOSA5426	15mm Shock Boot Set - (4).....	\$6.00
LOSA3522	F/R CV Driveshaft Axles - (2) .....	\$14.99	LOSA5429	Shock O-ring Set .....	\$2.50
LOSA3523	F/R CV Driveshaft Coupling Set - (2).....	\$5.50	LOSA5430	15mm Shock Bladders - (4).....	\$4.00
LOSA3524	F/R CV Driveshaft - (2)(8T) .....	\$28.99	LOSA5434	15mm Shock Ends, Cups & Bushings .....	\$7.00
LOSA3525	Center CV Rebuild Kit - (8)(8T).....	\$5.50	LOSA5438	Shock Stand Offs.....	\$10.00
LOSA3528	Center Front CV Driveshaft Assy (8T). .....	\$20.99	LOSA5440	15mm Shock Piston & Guide Set - (2).....	\$7.00
LOSA3529	Center Rear CV Driveshaft Assy (8T). .....	\$20.99	LOSA5453	15mm Springs 2.3" x 5.0 Rate Black .....	\$8.50
LOSA3530	Wheel Hexes(pr) Hard Ano.....	\$12.99	LOSA5461	15mm Springs 3.1" x 4.0 Rate Grey .....	\$8.50
LOSA3531	Wheel Nuts & Pins - 4ea; .....	\$7.50	LOSA6044	HD Rod Ends & Balls .....	\$5.00
LOSA3540	Brake Disk Set.....	\$12.99	LOSA6046	4mm Rod End Set .....	\$3.00
LOSA3541	Brake Pads & Screws .....	\$6.00	LOSA6047	5mm Rod End Set .....	\$3.00
LOSA3544	Brake Cam Set.....	\$16.99	LOSA6048	Suspension Balls 8.8mm Flanged .....	\$7.50
LOSA4002	Antenna Kit .....	\$2.25	LOSA6049	Suspension Balls 8.8mm .....	\$6.00
LOSA4003	Antenna Caps .....	\$1.25	LOSA6050	Steering Ball Set 6.8mm.....	\$4.50
LOSA4402	Main Chassis - Machined (8T).....	\$129.99	LOSA6109	5mm E-Clips .....	\$1.50
LOSA4407	Servo Saver Hardware (8T).....	\$12.99	LOSA6204	4-40 x 1/2" Caphead Screws (10).....	\$1.50
LOSA4408	Steering Post Set.....	\$6.00	LOSA6206	4-40 x 3/8" Caphead Screws (10).....	\$1.50
LOSA4409	Steering Bellcrank Plastics.....	\$6.00	LOSA6215	#4 Narrow Washers .....	\$1.35
LOSA4411	Steering Rack Set Short/Long & Hdw .....	\$10.99	LOSA6221	4-40 x 5/8" Caphead Screws (10).....	\$1.50

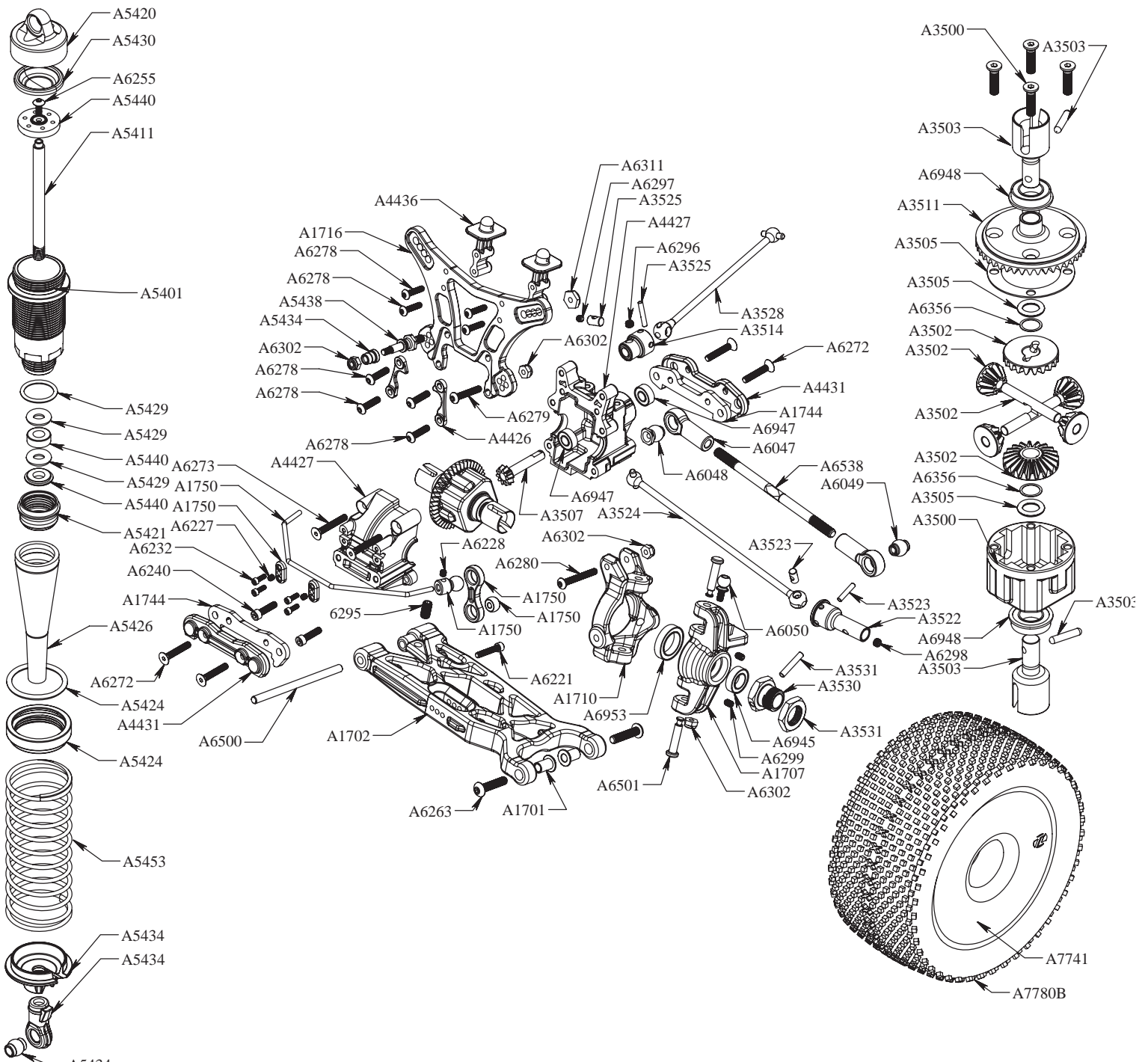

LOSA6227	4-40 Hardened Set Screws	\$1.80	LOSA6295	10-32 x 3/8" Oval Point Set Screws (4)	\$3.00
LOSA6228	5-40 Hardened Set Screws	\$1.80	LOSA6296	8-32 x 1/8" Flat Point Set Screws (8)	\$3.00
LOSA6232	2-56 x 1/4" Caphead Screws (10)	\$2.50	LOSA6297	5-40 x 1/8" Flat Point Set Screws (8)	\$2.50
LOSA6240	5-40 x 1/2" Caphead Screws (10)	\$2.50	LOSA6298	8-32 x 1/8" Cup Point Set Screws (8)	\$2.50
LOSA6254	2-56 x 1/2" Caphead Screws (10)	\$2.50	LOSA6299	5-40 x 1/8" Cup Point Set Screws (8)	\$2.50
LOSA6255	2-56 x 1/4" Button Head Screws (10)	\$2.50	LOSA6302	5-40 Lock Nuts - Steel	\$1.25
LOSA6256	4-40 x 1/2" Button Head Screws (10)	\$1.50	LOSA6306	4-40 Aluminum Mini Nuts (10)	\$3.50
LOSA6262	8-32 x 1/2" Flat Head Screws (10)	\$2.50	LOSA6311	8-32 Steel Lock Nuts (10)	\$2.00
LOSA6263	8-32 x 3/4" Button Head Screws (10)	\$2.50	LOSA6350	#4 and 1/8" Hardened Washers	\$2.50
LOSA6264	8-32 x 3/8" Flat Head Screws (10)	\$2.50	LOSA6351	#8 Countersink Washers (8)	\$4.00
LOSA6270	5-40 x 3/8" Flat Head Screws (10)	\$2.50	LOSA6500	Hinge Pins 4 x 66mm TiN (2)	\$11.00
LOSA6271	5-40 x 1/2" Flat Head Screws (10)	\$2.50	LOSA6501	Hinge Pins 4 x 21mm TiN (2)	\$8.50
LOSA6272	5-40 x 3/4" Flat Head Screws (10)	\$3.00	LOSA6502	Hinge Pin Studs (2)	\$4.50
LOSA6273	5-40 x 7/8" Flat Head Screws (4)	\$3.50	LOSA6537	Turnbuckles 3mm x 45mm w/ends	\$4.50
LOSA6274	5-40 x 1" Flat Head Screws (2)	\$4.00	LOSA6538	Turnbuckles 5mm x 92mm w/ends	\$7.99
LOSA6277	5-40 x 3/8" Button Head Screws (8)	\$4.00	LOSA6539	Turnbuckles 5mm x 100mm w/ends	\$7.99
LOSA6278	5-40 x 1/2" Button Head Screws (8)	\$4.00	LOSA6543	Turnbuckles 4mm x 98mm w/ends	\$7.99
LOSA6279	5-40 x 3/4" Button Head Screws (8)	\$4.00	LOSA6945	8x14x4 Rubber Sealed BB	\$11.99
LOSA6280	5-40 x 1" Button Head Screws (4)	\$2.50	LOSA6946	6x10x3 Rubber Sealed BB	\$11.99







LOSA4416 Alum. Front Chassis Brace



LOSA4417 Alum. Rear Chassis Brace



LOSB4604 17mm Wheel Wrench

## Option Parts

LOSA1708	Alum. Front Spindles .....	TBA	LOSA5450	15mm Springs 2.3" x 4.1 Rate Red .....	\$8.50
LOSA1711	Alum. Front Spindle Carriers .....	TBA	LOSA5451	15mm Springs 2.3" x 4.4 Rate Silver .....	\$8.50
LOSA1746	Rr Outer Pin Brace 3T/21 .....	\$11.99	LOSA5452	15mm Springs 2.3" x 4.7 Rate Green .....	\$8.50
LOSA1747	Rr Outer Pin Brace 2T/2A .....	\$11.99	LOSA5454	15mm Springs 2.3" x 5.3 Rate White .....	\$8.50
LOSA1749	Rr Outer Pin Brace 3T/3A .....	\$11.99	LOSA5455	15mm Springs 2.3" x 5.6 Rate Grey .....	\$8.50
LOSA3517	Center Diff 47T Spur Gear .....	\$24.99	LOSA5456	15mm Springs 3.1" x 2.5 Rate Red .....	\$8.50
LOSA4416	Alum. Front Chassis Brace .....	\$22.99	LOSA5457	15mm Springs 3.1" x 2.8 Rate Silver .....	\$8.50
LOSA4417	Alum. Rear Chassis Brace .....	\$16.99	LOSA5458	15mm Springs 3.1" x 3.1 Rate Green .....	\$8.50
LOSA4430	Al. Rear Gearbox Bearing Inserts .....	\$14.99	LOSA5459	15mm Springs 3.1" x 3.4 Rate Black .....	\$8.50
LOSA5277	Silicon Fluid, 1000cs .....	\$7.50	LOSA5460	15mm Springs 3.7" x 3.7 Rate White .....	\$8.50
LOSA5278	Silicon Fluid, 2000cs .....	\$7.50	LOSA5462	15mm Springs 3.7" x 4.3 Rate Purple .....	\$8.50
LOSA5279	Silicon Fluid, 3000cs .....	\$7.50	LOSA7740	Truggy Wheels White 17mm Hex (4ea) .....	\$23.99
LOSA5280	Silicon Fluid, 5000cs .....	\$7.50	LOSA9112	Clutch Springs - Black (.036" 25 Deg) .....	\$5.00
LOSA5281	Silicon Fluid, 7000cs .....	\$7.50	LOSA9113	Clutch Springs - Green (.036" 30 Deg) .....	\$5.00
LOSA5282	Silicon Fluid, 10,000cs .....	\$7.50	LOSA9116	Clutch Bell 13T .....	\$18.99
LOSA5283	Silicon Fluid, 15,000cs .....	\$7.50	LOSA9118	Clutch Bell 15T .....	\$18.99
LOSA5284	Silicon Fluid, 20,000cs .....	\$7.50	LOSA9119	Clutch Bell 16T .....	\$18.99
LOSA5285	Silicon Fluid, 30,000cs .....	\$7.50	LOSB4604	17mm Wheel Wrench .....	\$22.99
LOSA5286	Silicon Fluid, 50,000cs .....	\$7.50			

# TEAM LOSI EIGHT

Team Losi has a revered heritage in the fuel business having produced the most popular racing fuel for a number of years prior to turning their attention exclusively to the manufacture of electric off-road cars. The new Nitrotane brand fuel has been developed by some of the most knowledgeable and successful nitro racers spanning over 4 decades. The key elements achieved include easy starting, clean running and superior protection and performance. With a complete oil formulation laboratory and unmatched testing facilities at their disposal, Team Losi has the unique ability to create a specific lubrication package as well as maintain the highest standards in quality control. Only the most advanced blending techniques and absolute highest grades of methyl alcohol, genuine US made nitromethane, and hi-tech lubricants are used. Nitrotane uses both castor and synthetic oils as well as exclusive additives to provide performance and protection for all types of sport and ready to run engines while you learn the finer points of the sport. Synthetic lubricants provide excellent hi-penetration lubricity and clean crisp throttle response. Castor oil provides exceptional high temperature lubrication and over-lean protection. Exclusive power and anti foaming agents as well as corrosion inhibitors are used to provide stability and peak performance in extreme nitro environments. Team Losi goes the extra step in every aspect, as even the container is special. Unlike most fuels, Nitrotane comes in a UN approved steel can to prevent leakage, photosensitive degradation and contamination. This means each tank of fuel will yield consistent and reliable power while burning clean and offering the highest level of protection and performance.



Team Losi - A Division of Horizon Hobby Inc.  
4710 E. Guasti Road, Ontario, CA 91761  
(909) 390-9595 Fax:(909) 390-5356  
[www.TeamLosi.com](http://www.TeamLosi.com) - [feedback@TeamLosi.com](mailto:feedback@TeamLosi.com)